



**MAX BLANK**  
HIGH QUALITY

# NANTES L Steel / Crystal / Stone

wood or pellet  
without electricity

## Technical specifications of the round stove:

measurements (cm)	width	height	depth
stove	58 / 62 / 62	168,5	60 / 62 / 62
combustion chamber	37	30	29
fire glass	34	46	
fire door	47	64	
<b>flue pipe connection Ø 15 to → or ↑</b>			
height to top pipe socket			123
height to pipe socket rear			178
<b>outside air connection Ø 10 to → or ↓</b>			
height to mid connection horizontal			6,5
depth to mid connection vertical			29 / 31 / 31
<b>total weight</b>	<b>chamotte bricks</b>	<b>heat accumulator</b>	
213 / 250 / 450 kg	26 kg	80 kg	
<b>data for</b>	<b>pellet box S</b>	<b>pellet box XL</b>	<b>wood</b>
nominal heat output	7,5 kW	11 kW	6,5 kW
output range	7,5 - 5 kW	11 - 8,5 kW	6,5 - 3,3 kW
efficiency	86%	85%	87%
heating capability*	50 - 150 m³	70 - 250 m³	70 - 250 m³
amount of fuel	3,8 kg	7,5 kg	2,9 kg / h
fire duration	up to 2,5 h	up to 5 h	up to 5 h
heat release	up to 10 h	up to 14 h	up to 18 h
flue gas flow volume	8,97 g/s	10,74 g/s	10,3 g/s
exhaust °C (nozzle)	180 °C	230 °C	268°C
min/max feed press.	12 / 15 Pa	13 / 15 Pa	12 / 15 Pa
CO (13%/O2) [mg/m³]	1166	880	1074
CO (13%/O2) [%]	0,093	0,070	0,086
dust (13%/O2) [mg/m³]	36	30	31
NOx (13%/O2) [mg/m³]	109	110	115
CxHy (13%/O2) [mg/m³]	54	41	51
wall distance, rear	15 cm	20 cm	15 cm
wall distance, side	15 cm	15 cm	15 cm
distance to the front	80 cm	80 cm	80 cm

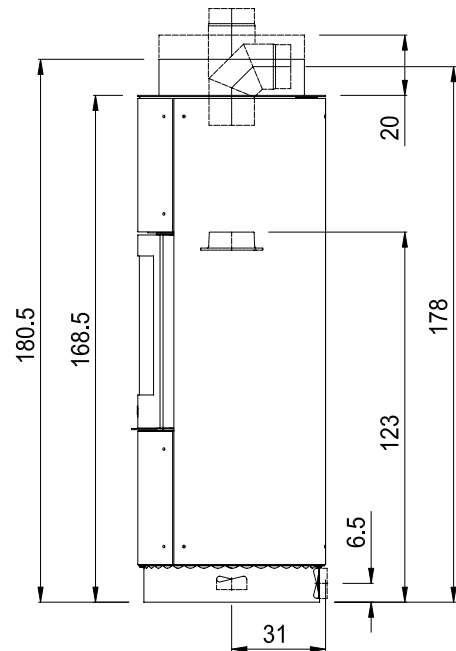
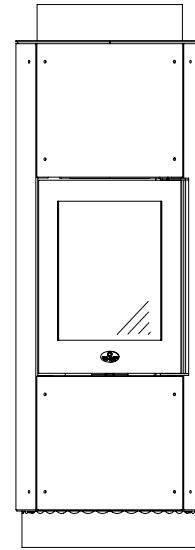

Fulfils the latest standards in burning wood, wood-briquettes and pellets (please see applicable standards).

**Please check the instruction manual for this wood & pellet burning stove.**

Suitable for multiple chimneys.

\* depending on stove location in the living area, room isolation, height of the room and amount of fuel

Subject to alterations; errors including printer's errors.

**Our specialised stove builders and retailers will assist you with practical advice.**

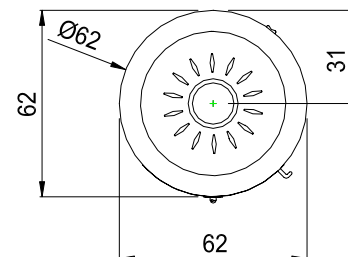

## Round stove, model Nantes L

ENR	model	delivery time	
226-2201	<b>Nantes L Steel</b> † <ul style="list-style-type: none"> <li>• stove body steel anthracite</li> <li>• fire door, base and top cover in black</li> </ul>	4	
224-2101	<b>Nantes L Crystal</b> † <ul style="list-style-type: none"> <li>• stove body crystal in shiny black</li> <li>• fire door, base and top cover in black</li> </ul>	3	
224-2201	<b>Nantes L Crystal</b> † <ul style="list-style-type: none"> <li>• stove body crystal glass white matted</li> <li>• fire door, base and top cover in black</li> </ul>	4	
225-2201	<b>Nantes L Stone</b> † <ul style="list-style-type: none"> <li>• stove body stone light grey blasted</li> <li>• fire door, base and top cover in black</li> </ul>	4	
225-2101	<b>Nantes L Stone</b> † <ul style="list-style-type: none"> <li>• stove body stone creamed lined</li> <li>• fire door, base and top cover in black</li> </ul>	4	
227-2201	<b>Nantes L Crystal Light 'n' Fire (LED)</b> † <ul style="list-style-type: none"> <li>• stove body crystal glass white matted with luminous-colour-wellness-experience</li> <li>• fire door, base and top cover in black</li> </ul>	4	
<b>pellet accessories for the round stove</b>			
552-2014	<b>pellet box S with 7,5 kW (at purchase with a stove)</b>		
552-2004	<b>pellet box S with 7,5 kW (retrofit kit)</b> <b>pellet box XL with 11 kW (at purchase with a stove)</b> <b>pellet box XL with 11 kW (retrofit kit)</b> <ul style="list-style-type: none"> <li>• from heat-resistant stainless steel</li> <li>• at model S with 2, at XL with 3 black ceramic special glasses</li> <li>• with lighter, silicone gloves, pellet-felt bag up to 20 kg, cleaning brushes, pellet shovel provided</li> </ul>		
40651-016	high hood (12 cm)		
40650-016	extra high hood (20 cm): covers the outgoing pipe on the side or backwards		
303224-916	<b>additional heat accumulating elements for Nantes</b>  <b>on request with stone lid in either:</b> <ul style="list-style-type: none"> <li>- natural stone light grey blasted</li> <li>- natural stone chiselled grey</li> </ul>		
16280-016	<b>base for rotatable version</b>  Outside air connection is prepared: <b>Be sure to specify when ordering:</b> <b>outside air connection horizontal or vertical</b> (is included in scope of delivery)		
<b>special features of the round stove</b>			
<p>Heat without electrical power and use all advantages of this double feature oven: pellet AND wood!            Simple and very easy swap between wood or pellet within a minute!</p> <p>Discover the special features of our fire-combo-romantic on YouTube!</p> <p><b>The round stove Nantes L Light 'n' Fire (LED)</b></p> <p>The Nantes L Light 'n' Fire offers atmospheric ambience throughout the year.            The wireless remote control offers 5 different programs as well as 15 change of colour in different strengths. The rather low power use is also an advantage, only 55 Watt under full throttle and only 6 Watt in standby.</p> <p>The round stove Nantes L Stone, in the light grey edition as well as with heat accumulator which brings heat distribution up to 18 hours.</p> <ul style="list-style-type: none"> <li>• all editions are available with an additional heat accumulator</li> <li>• also available as a rotatable edition</li> <li>• choose your stainless steel or glass floor protector from the list of accessories</li> </ul> <p style="text-align: center;"><b>Please also look up the features of the natural stone collection!</b></p>			