



MAX BLANK
HIGH QUALITY

RAVENNA

**wood or pellet
without electricity**

Technical specifications of the accumulation heater:

measurements (cm)	width	height	depth
stove	57,5	115	48,5
combustion chamber	37	30	29
fire glass	34	47,5	
fire door	49,5	70,5	
flue pipe connection Ø 15 to → or ↑ height to top pipe socket			109,5
outside air connection Ø 10 to → or ↓ height to mid connection horizontal			47
depth to mid connection vertical			13,5
total weight	chamotte bricks	heat accumulator	
212 kg	26 kg	-	
data for	pellet box S	pellet box XL	wood
nominal heat output	7,5 kW	11 kW	6,5 kW
output range	7,5 - 5 kW	11 - 8,5 kW	6,5 - 3,3 kW
efficiency	86%	85%	87,1%
heating capability*	50 - 150 m³	70 - 250 m³	70 - 250 m³
amount of fuel	3,8 kg	7,5 kg	2,9 kg / h
fire duration	up to 2,5 h	up to 5 h	up to 5 h
heat release	up to 7 h	up to 10 h	up to 10 h
flue gas flow volume	8,97 g/s	10,74 g/s	10,3 g/s
exhaust °C (nozzle)	180 °C	230 °C	268 °C
min/max feed press.	12 / 15 Pa	13 / 15 Pa	12 / 15 Pa
CO (13%/O2) [mg/m³]	1166	880	1074
CO (13%/O2) [%]	0,093	0,070	0,086
dust (13%/O2) [mg/m³]	36	30	31
NOx (13%/O2) [mg/m³]	109	110	115
CxHy (13%/O2) [mg/m³]	54	41	51
wall distance, rear	15 cm	20 cm	15 cm
wall distance, side	15 cm	15 cm	15 cm
distance to the front	80 cm	80 cm	80 cm

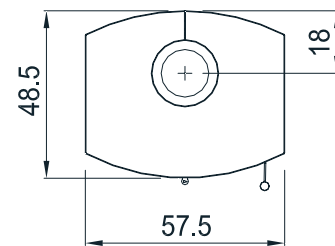
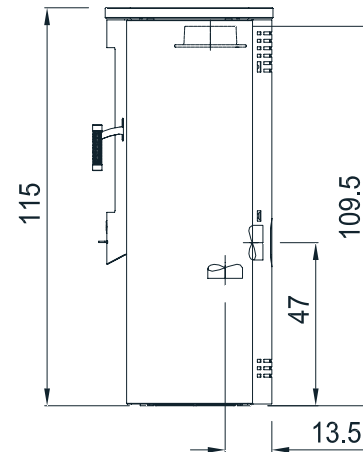
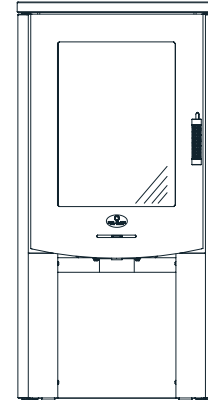

Fulfills the latest standards in burning wood, wood-briquettes and pellets (please see applicable standards).

Please check the instruction manual for this wood & pellet burning stove.

Suitable for multiple chimneys.

* depending on stove location in the living area, room isolation, height of the room and amount of fuel

Subject to alterations; errors including printer's errors.

Our specialised stove builders and retailers will assist you with practical advice.

Heat storing stove, model Ravenna

ENR	model	delivery time	
125-2010	Ravenna † <ul style="list-style-type: none"> • Front anthracite • side panels in natural stone cream flamed • with natural stone top cover in cream flamed 	4	
125-2013	Ravenna † <ul style="list-style-type: none"> • Front anthracite • side panels in natural stone anthracite flamed • with natural stone top cover in anthracite flamed 	4	
pellet accessories for the heat storing stove			
552-2014	pellet box S with 7,5 kW (at purchase with a stove) pellet box S with 7,5 kW (retrofit kit)		
552-2004	pellet box XL with 11 kW (at purchase with a stove) pellet box XL with 11 kW (retrofit kit) <ul style="list-style-type: none"> • from heat-resistant stainless steel • at model S with 2, at XL with 3 black ceramic special glasses • with lighter, silicone gloves, pellet-felt bag up to 20 kg, cleaning brushes, pellet shovel provided 		
29 125 311	floor protector stainless steel (see accessories) especially for this stove type Outside air connection is prepared: Be sure to specify when ordering: outside air connection horizontal or vertical (is included in scope of delivery) For other connection accessories, please see list of accessories.		
special features of the heat storing stove, model Ravenna			
<p>Heat without electrical power and use all advantages of this double feature oven: pellet and wood. Simple and very easy swap between wood or pellet within a minute. Discover the special features of our fire-combo-romantic on YouTube. Free to choose fuel makes you more independent. Get whatever is cheapest at the moment and save money.</p> <p>The heat accumulating stove, model Ravenna</p> <ul style="list-style-type: none"> • rounded rear wall, makes a bevelled installation possible • elegant and timeless stove front • rock as natural heat accumulator • high radiant heat • adjustable feet for a stable set up • more special features and extras at the last pages • choose your stainless steel floor protector from the list of accessories, ...easy to remove during summer times <p style="text-align: center;">Please also look up the features of the natural stone collection!</p>			