



MAX BLANK
HIGH QUALITY

BELFORT XS

wood

Technical specifications of the system fireplace:

measurements (cm)	width	height	depth
stove	128	130	52
combustion chamber	61	24	27
fire glass	59,5	30	
fire door	85	47	
flue pipe connection Ø 15 to ↑ height to pipe socket above			96,5
outside air connection Ø 10 to → or ↓ depth to mid connection vertical			20
total weight	chamotte bricks	heat accumulator	
563 kg	30 kg	81 kg	
data for	wood stove		
nominal heat output	6,7 kW		
output range	8 - 5 kW		
efficiency	80%		
heating capability*	70 - 350 m ³		
amount of fuel	2,0 kg / h		
fire duration	- 4 h		
heat release	- 9 / - 15 h		
flue gas flow volume	6,6 g / s		
exhaust °C (nozzle)	296 °C		
min/max feed press.	12 / 15 Pa		
CO (13%/O ₂) [mg/m ³]	1244		
CO (13%/O ₂) [%]	0,100		
dust (13%/O ₂) [mg/m ³]	21		
NO _x (13%/O ₂) [mg/m ³]	163		
CxHy (13%/O ₂) [mg/m ³]	66		
wall distance, rear	4 cm		
wall distance, side	6 cm		
distance to the front	100 cm		

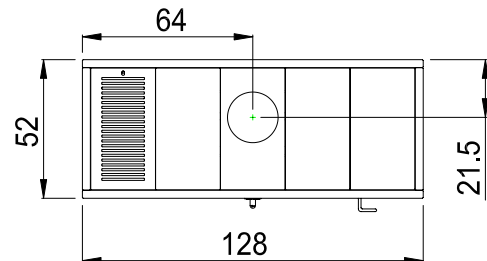
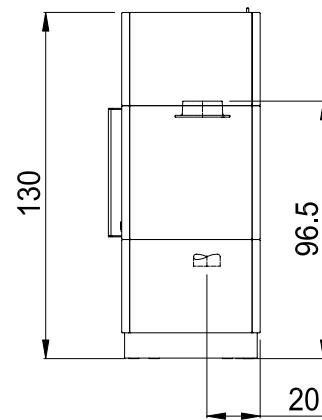
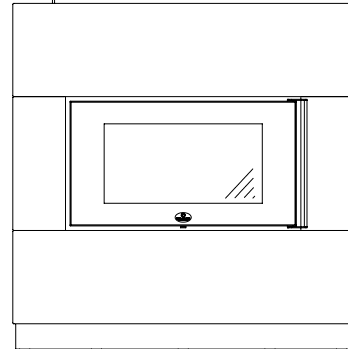

Fulfills the latest standards in burning wood and wood-briquettes (please see applicable standards).

Please check the instruction manual for this wood burning stove.

Suitable for multiple chimneys.

* depending on stove location in the living area, room isolation, height of the room and amount of fuel

emission value at 50 cm flue pipe outlet

Subject to alterations; errors including printer's errors.

Our specialised stove builders and retailers will assist you with practical advice.

System-fireplace, model Belfort XS

ENR	model	delivery time	
379-2101	Belfort XS ↑ <ul style="list-style-type: none"> • door cover anthracite • door facet stainless steel • surrounded at 4 sides by natural stone white-cream smooth • door hinge at the left hand side 	6	
379-2601	Belfort XS ↑ <ul style="list-style-type: none"> • door cover anthracite • door facet stainless steel • surrounded at 4 sides by natural stone cream grooved • door hinge at the left hand side 	6	
379-2201	Belfort XS ↑ <ul style="list-style-type: none"> • door cover anthracite • door facet stainless steel • surrounded at 4 sides by natural stone white-cream smooth with smooth edges with smooth 	6	
379-2099	Belfort XS ↑ <ul style="list-style-type: none"> • choose the default stove body form the above mentioned types • middle stripes front & side to be chosen out of: <ul style="list-style-type: none"> - natural stone white-cream smooth - natural stone white-cream smooth with rounded corners - natural stone cream ribbed - natural stone cream hewed - natural stone brushed slate 	6	
accessories for the system-fireplace			
303 379-916	4 piece additional heat accumulating element with 81 kg you can find more Belfort-accessories in the list of accessories outside air connection to the bottom (is included in scope of delivery) Lid bundle I or II for smoke flue back/top (is included in scope of delivery) contents description on the last pages For other connection accessories, please see list of accessories.		
special features of the system-fireplace, model Belfort XS			
<ul style="list-style-type: none"> • quick assembling within 1/2 day for 2 people • no dirt or dust during construction • no filling, no glue, no cementing • saves heat the natural way • dispenses heat on a large surface spread over 4 sides • sustainable through natural materials • degradable and movable without damaging the fire place • comfortable and self-closing fire door • can take fire logs up to 55 cm • fire technology without high-maintenance dust filters • optional heat accumulation <p style="text-align: center;">Please also look up the features of the natural stone collection!</p>			