



**MAX BLANK**  
HIGH QUALITY

# ANGEL FALLS

wood

**Technical specifications of the fireplace with waterfall:**

measurements (cm)	width	height	depth
stove	116	213,5	67,5
combustion chamber	61	24	27
fire glass	59,5	30	
fire door	85	47	
<b>flue pipe connection Ø 15 to → or ↑</b>			
height to pipe socket above			86,5
height to mid flue pipe outlet rear			70,5
height to mid 2. flue pipe outlet rear			150,5
<b>outside air connection Ø 10 to → or ↓</b>			
height to mid connection horizontal			25
depth to mid connection vertical			8,5
total weight	chamotte bricks	heat accumulator	
642 kg	30 kg	-	
<b>data for</b>	<b>wood stove</b>		
nominal heat output	6,7 kW		
output range	8 - 5 kW		
efficiency	80%		
heating capability*	70 - 350 m³		
amount of fuel	2,0 kg / h		
fire duration	- 4 h		
heat release	- 7 h		
flue gas flow volume	6,6 g / s		
exhaust °C (nozzle)	296 °C		
min/max feed press.	12 / 15 Pa		
CO (13%/O2) [mg/m³]	1244		
CO (13%/O2) [%]	0,100		
dust (13%/O2) [mg/m³]	21		
NOx (13%/O2) [mg/m³]	163		
CxHy (13%/O2) [mg/m³]	66		
wall distance, rear	4 cm		
wall distance, side	6 cm		
distance to the front	100 cm		
water on wall	max 15 l / min		
water tank	usable fill approx. 17 l		
(integrated drawer)	fill incl. system requirements approx. 35 l		
water evaporation	within 24 hours at room temp. 24 °C approx. 4l or a water tank fill lasts for 96 hours (without fire) 12 l within 24 hours with fire burning		
protection class	IP 68		
operating voltage	230 Volt		
power input	75 Watt		
connection lead	approx. 10 meter		
hose connector	3/4 in at discharge site		

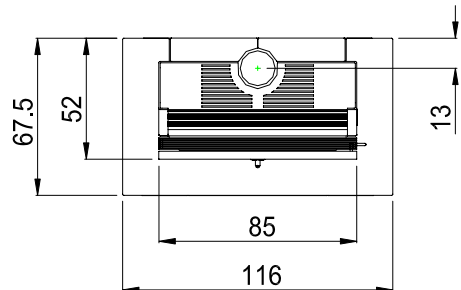
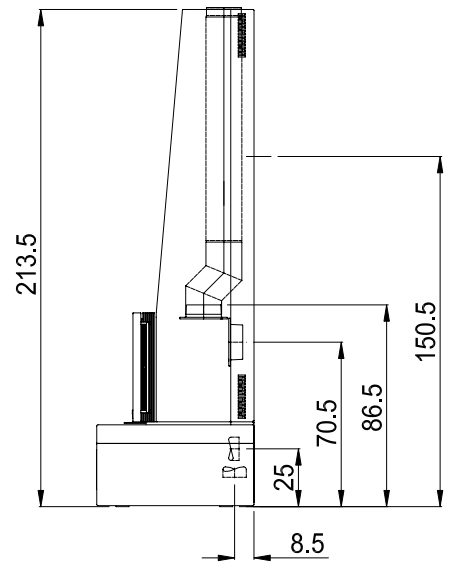
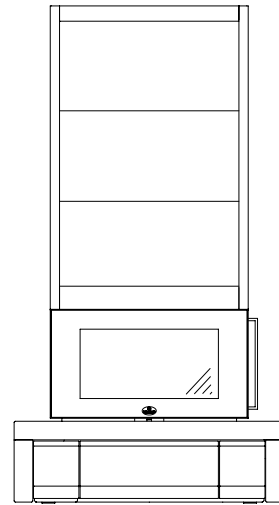

Fulfils the latest standards in wood- and wood briquette-norms (please see applicable standards).

**Please check the instruction manual for this wood burning stove.**

Suitable for multiple chimneys.

\* depending on stove location in the living area, room isolation, height of the room and amount of fuel

emission value at 50 cm flue pipe outlet

Subject to alterations; errors including printer's errors.

## Fireplace with waterfall, model Angel Falls

ENR	model	delivery time	
365-2001	<b>Angel Falls →</b> <ul style="list-style-type: none"> <li>• stone board in cream smooth</li> <li>• stove body cafe-brown</li> <li>• door facet stainless steel</li> <li>• wave texture crafted water wall from special white stone</li> <li>• incl. pump, remote control and dry running protection</li> </ul>	12	
<b>accessories for the fireplace with waterfall</b>			
29 365 311	<b>floor protector stainless steel (see accessories)</b>		
29 365 400	<b>floor protector glass (see accessories)</b>		
<p>especially for this stove type</p> <p>outside air connection possible: air inlet horizontal or vertical</p>			
<b>special features of the fireplace with waterfall, model Angel Falls</b>			
<ul style="list-style-type: none"> <li>• waterfall on corrugated graded stone levels</li> <li>• massive stone board</li> <li>• with large integrated water tray</li> <li>• switch for automated water level control</li> <li>• wireless remote control</li> <li>• many parts made of high-quality stainless steel</li> <li>• fascinating play of fire &amp; water</li> <li>• humidifier during winter as well as summer</li> <li>• comfortable interior climate</li> <li>• additional advantage: reduce &amp; binding dust</li> <li>• patented self-locking door handle</li> <li>• wall distance of only 4cm***</li> <li>• wide combustion chamber of over 60 cm</li> <li>• attractive horizontal architecture</li> <li>• adjustable feet for a stable set up</li> <li>• lateral smoke flue possible</li> </ul> <p>***The wall distance of 4 cm depends on the stoves installation site. Requirement is the inspection through the responsible chimneysweeper in you jurisdiction. The rear of the stove will heated up to 65 °C (if smoke flue is installed on top).</p> <ul style="list-style-type: none"> <li>• further special features and extras at the last pages</li> <li>• choose your floor protector in glass or stainless steel from the list of accessories,</li> </ul> <p><b>easy to remove during summer times</b></p>			
<p>The used oils have to be soluble in water, otherwise the hydrologic balance could be impacted negatively.</p> <p>Attention: It is recommended to use purified water.</p>			
<p><b>Do not operate the stove without reading the manual and instructions.</b></p> <p><b>Please also look up the features of the natural stone collection!</b></p>			